



QUICKGUIDE

STEP OSDP Cardreader with Keypad

Edition 1



Manual



When it has to work.

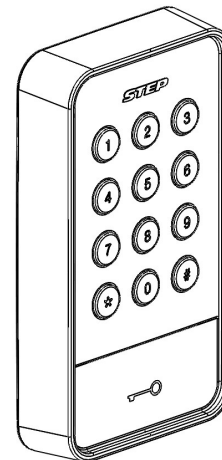

In the package

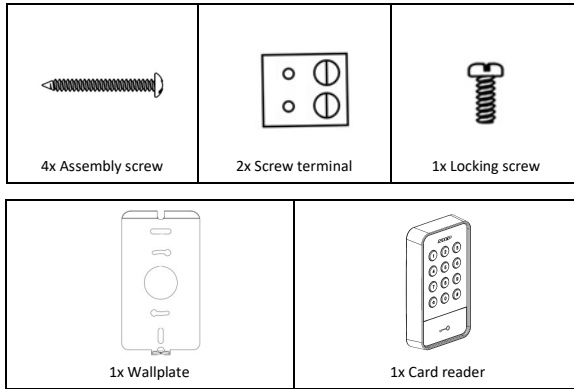

Address switch

The device have an manual address switch.

In case only one card reader is used on the Door controller leave device with address 0.

If you have several devices on same bus set first reader to 0 second to 1 and third to 2 and so on.

Address is set with a screw drive gently screw it clock wise

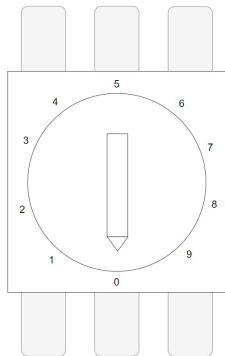

Cable

Connect your 2 pair cable as below, Power to **CON3** and OSDP to **CON2**.

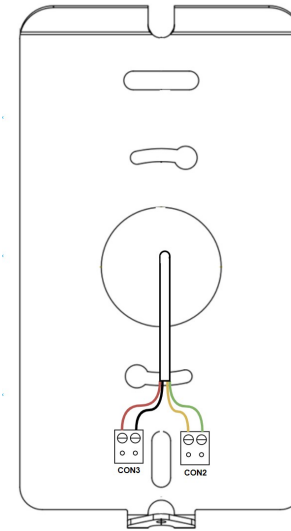

Terminal description

Please note that this is only a quick installation guide, information regarding recommendations, measurements are available in the full installations guide

CON2

| PIN | Description |
|-----|-------------|
| A | RS-485 + |
| B | RS-485 - |

CON3

| PIN | Description |
|-----|------------------------|
| DC+ | Power supply 10-30 Vdc |
| GND | Power supply ground |